



**SINGLE USER**

**03**

**APPROVAL  
MATRIX**

**Approver Limit**



## STEP 1

### CORPORATE ADMINISTRATOR (CA) TO SET APPROVAL MATRIX FOR TRANSACTION.

The Approval Matrix  
needs to be  
set/changed for the  
transaction limit  
Approver to approve.

Click:  
**IB Service  
Administration.**

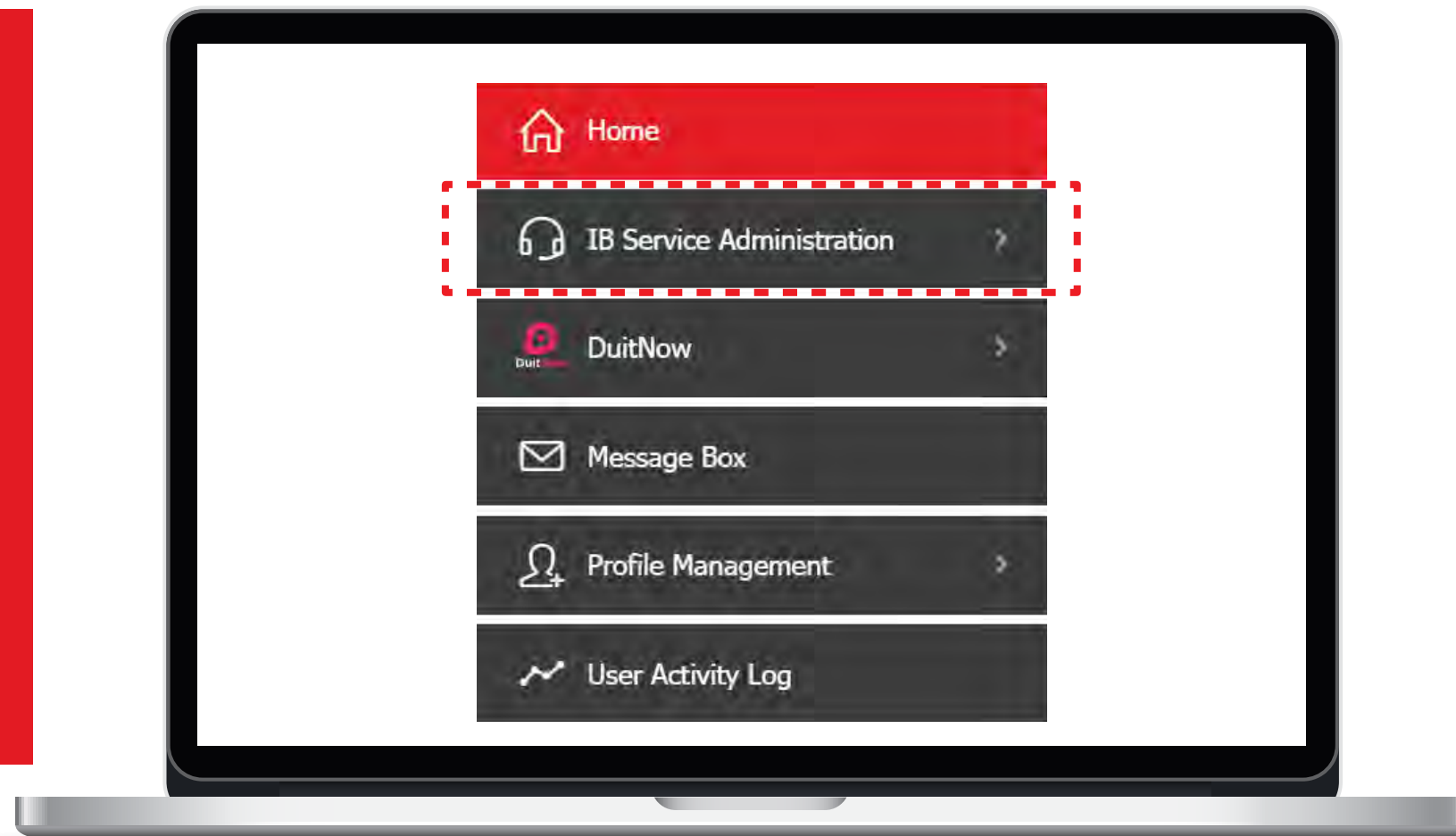

## STEP 2

Click:  
Edit **Approval Matrix**.

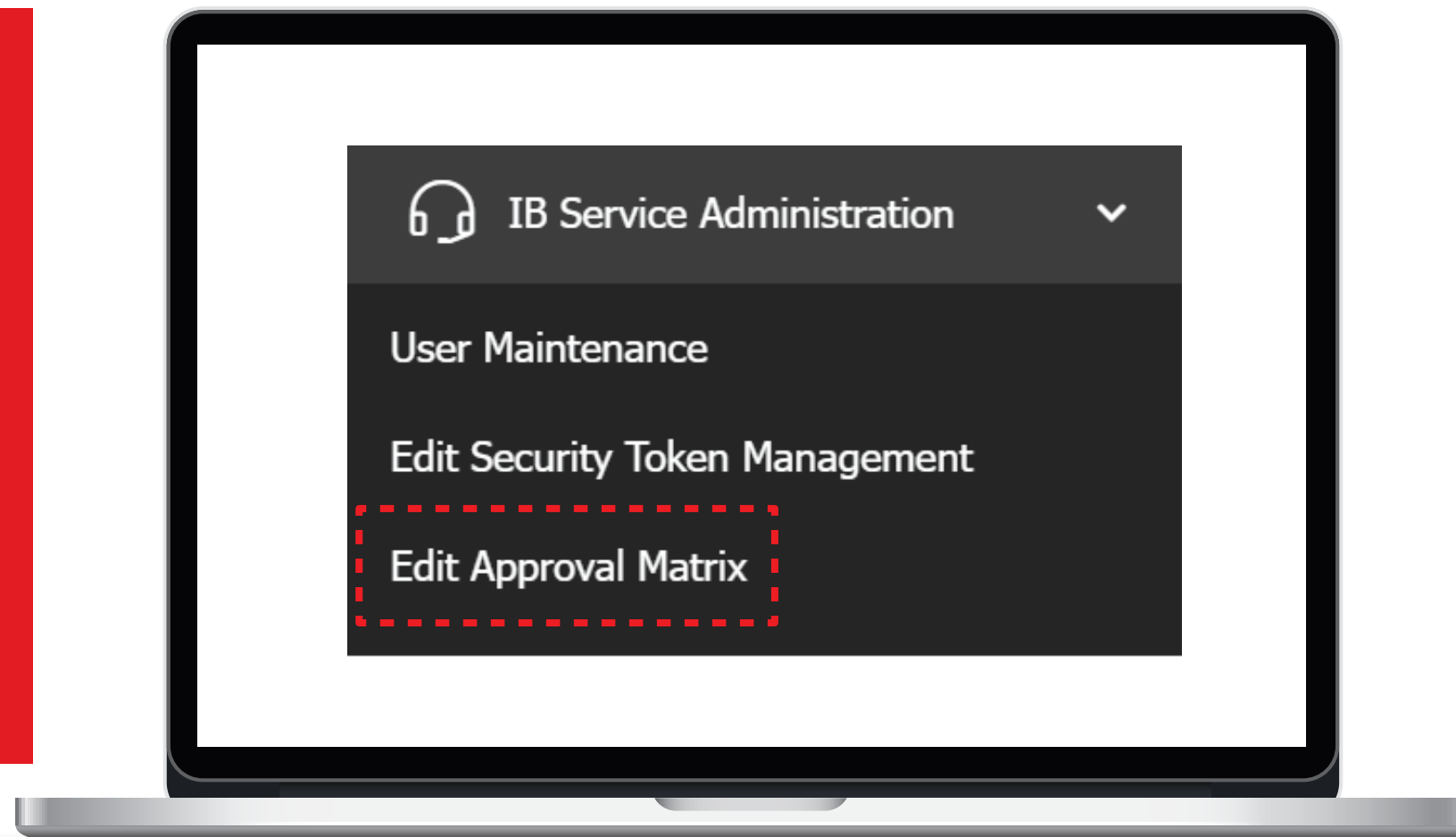

## STEP 3

Click:  
Add.

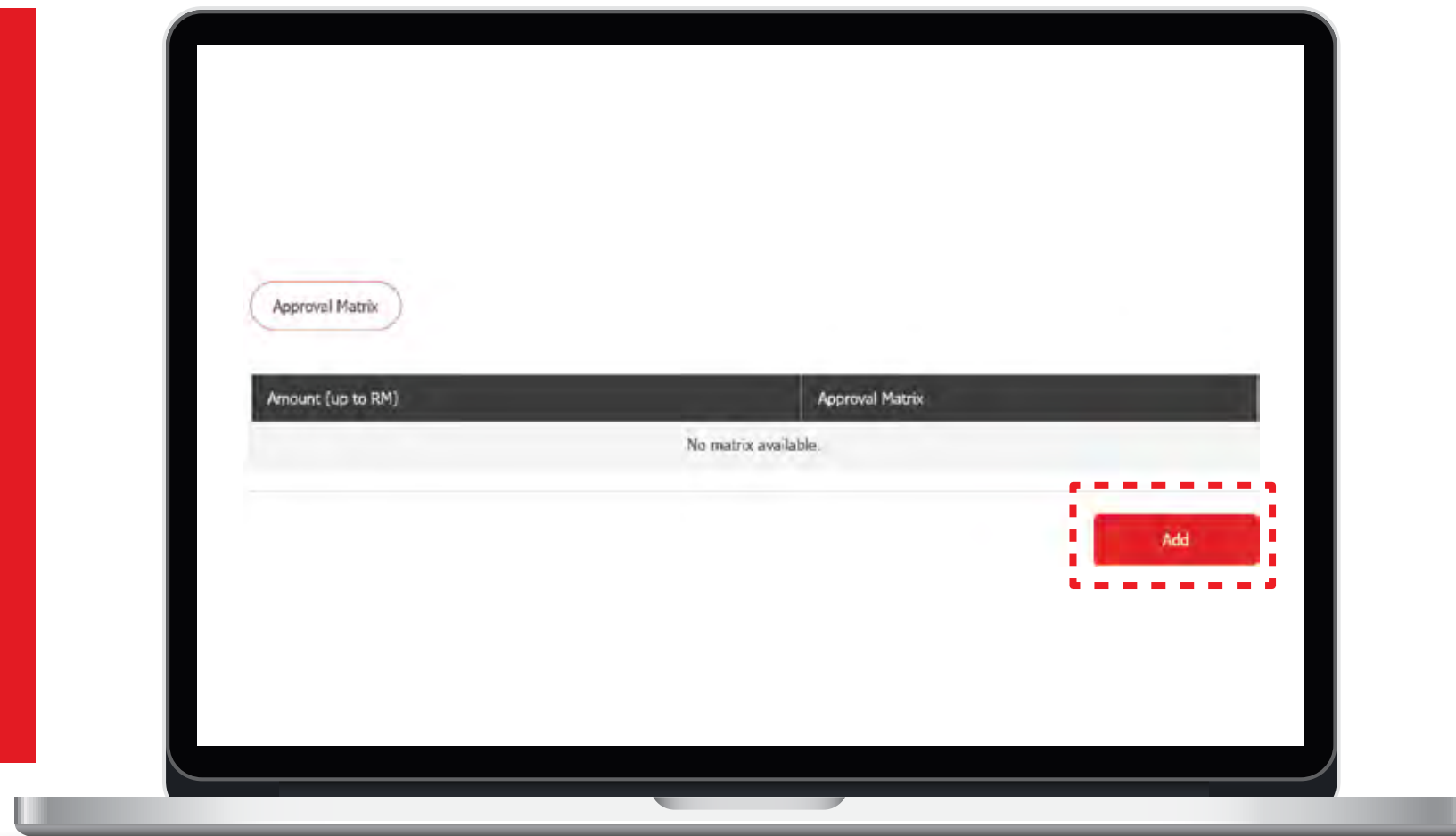

## STEP 4

1. Click:  
 to drop the bar.
2. **Corporate Administrator (CA)** to set any amount in the **Amount** (up to RM) box to limit the transaction amount. Maximum is RM500000.
3. Tick ☒ in action box.
4. Set number 1 in **Group A** box.
5. Click: **Next** and **Confirm**.

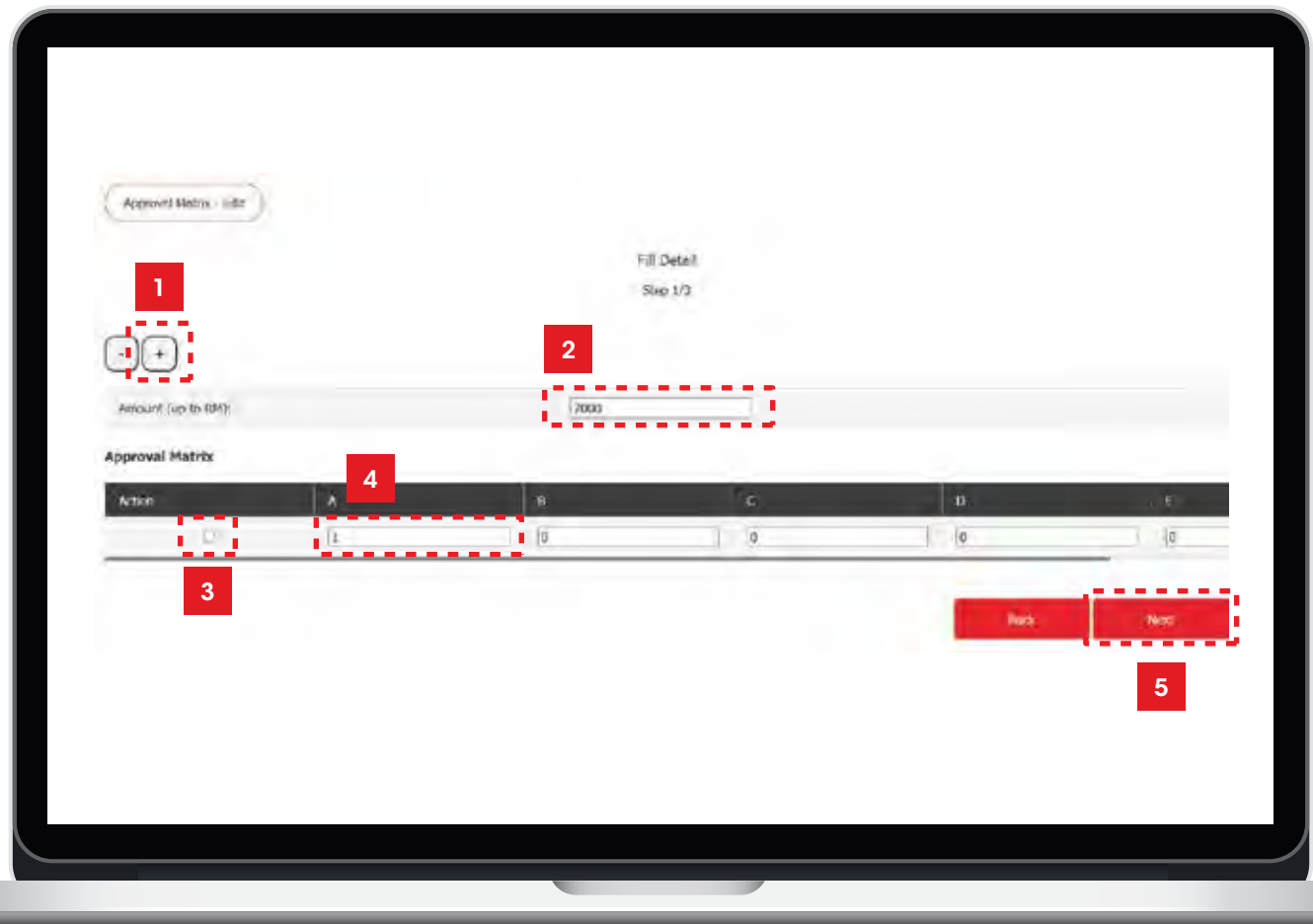

Approval Matrix - edit

Fill Detail  
Step 1/2

1

2

Amount (up to RM): 7000

Approval Matrix

Action	A	B	C	D	E
<input checked="" type="checkbox"/>	1	0	0	0	0

3

4

5

Back Next

## YOUR APPROVAL MATRIX COMPLETED FOR SINGLE USER.

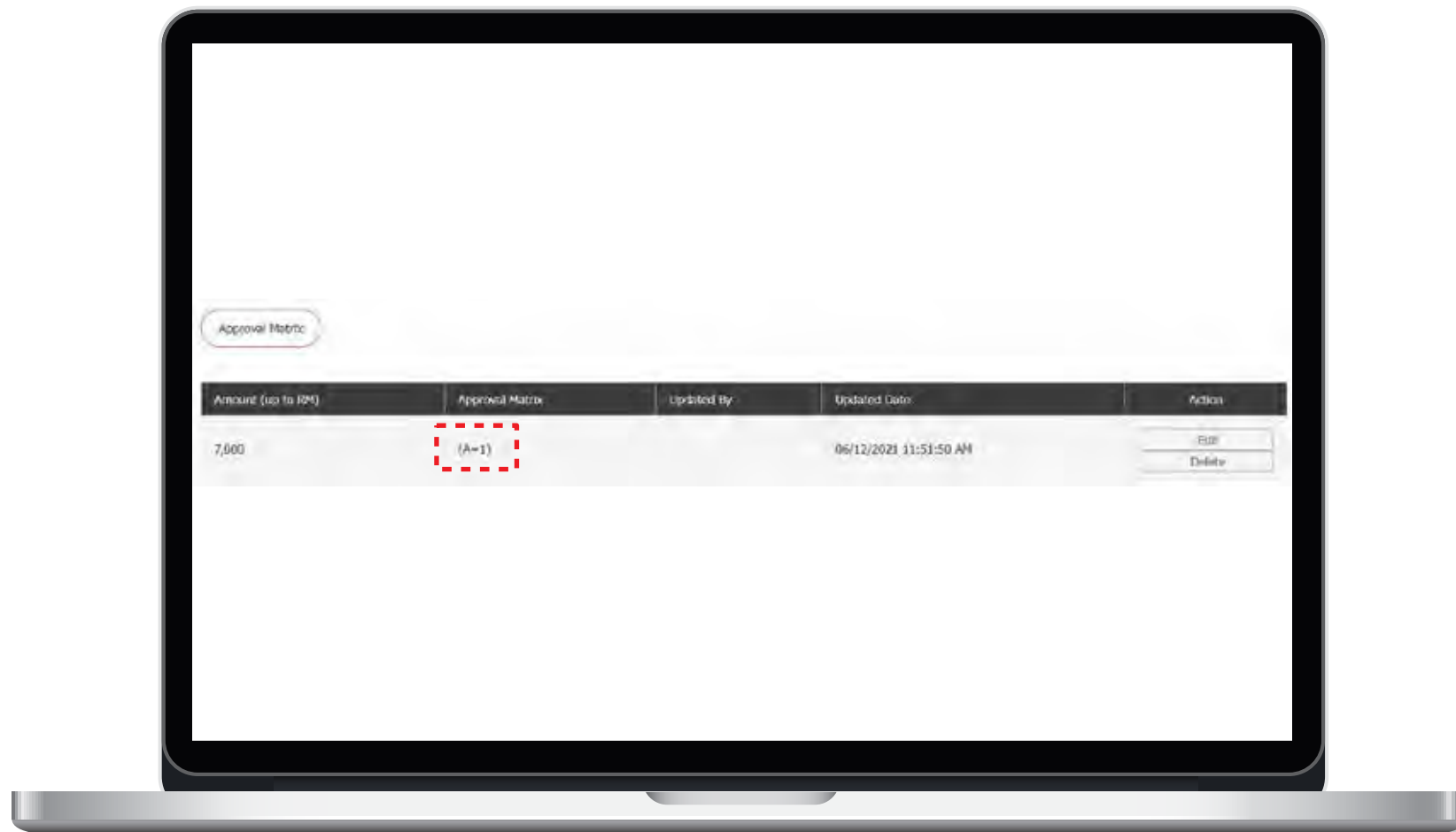

Please refer to the next guidance

## 04 |

- **FIRST TIME LOG IN**
- **ACTIVATION NEW SECURITY TOKEN**

---



For further information and inquiries,  
please contact Agrobank Contact Centre at 1-300-80-2476, visit any Agrobank branch,  
or visit the Agrobank website [www.agrobank.com.my](http://www.agrobank.com.my).